

Installation and operating instructions

# JUDO PIPE-CARE SYSTEM JPCS-FB

Micro-leakage protection system with integrated backwash protective filter and  
limescale prevention unit  $\frac{3}{4}$ " -  $1\frac{1}{4}$ "

Valid for: EU-countries and Switzerland

Language: English

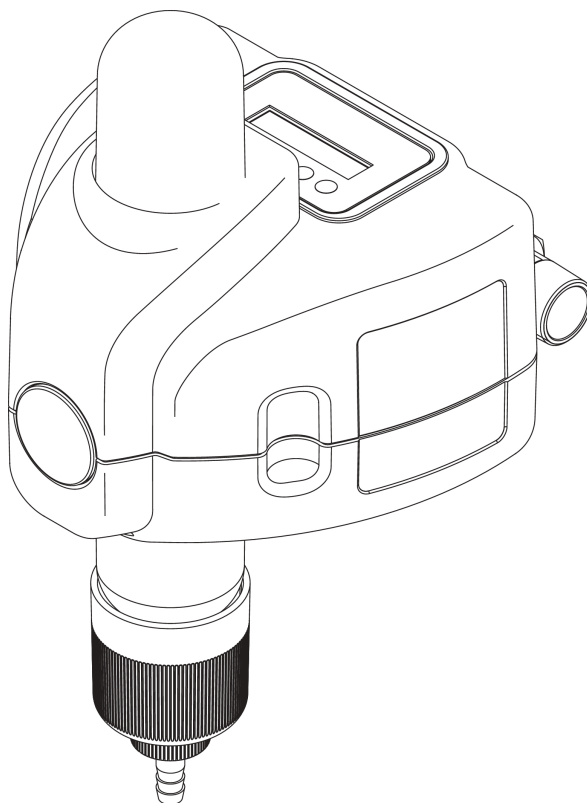

Read before use and store!

CE

**Judo**®

---

---

## Queries, orders, customer service

JUDO Wasseraufbereitung GmbH  
Postfach 380  
D-71351 Winnenden

Email: [info@judo.eu](mailto:info@judo.eu) • [judo.eu](http://judo.eu)

### Office address:

JUDO Wasseraufbereitung GmbH  
Hohreuschstraße 39 - 41  
D-71364 Winnenden

Dear customers,

**Thank you for the confidence you have shown in us by purchasing this product. You have purchased a state-of-the-art device. It has been carefully checked prior to delivery. Nevertheless, if difficulties occur, please contact the closest customer service (see chapter Customer service).**

### Trademarks:

Trademarks used in this document are the protected and registered trademarks of the owners.

© JUDO Wasseraufbereitung GmbH  
D-71364 Winnenden  
All rights reserved.

Reprinting, even in excerpt form, is only permitted with special approval.

These installation and operating instructions are intended for both installers, who are in charge of installing, maintaining or repairing the device, and for the operators of the device.

# Contents

<b>1</b>	<b>Safety.....</b>	<b>4</b>	5.10	Displaying operating data and information.....	29
1.1	Intended use.....	4	<b>6</b>	<b>Remote control and Remote transmission of messages.....</b>	<b>30</b>
1.2	Application limits.....	4	6.1	External messages.....	30
1.3	Safety instructions.....	4	6.2	Control via app.....	30
1.4	Symbols used.....	7	6.3	Further options within the app.....	32
1.5	Units used.....	7	6.4	Control via Amazon Alexa.....	32
1.6	Normative basics.....	7	<b>7</b>	<b>Fault domestic water station....</b>	<b>33</b>
<b>2</b>	<b>Product information.....</b>	<b>7</b>	<b>8</b>	<b>Warning message / fault leakage protection system.....</b>	<b>34</b>
2.1	Scope of supply.....	7	<b>9</b>	<b>Servicing.....</b>	<b>37</b>
2.2	Function description.....	7	9.1	Cleaning.....	37
2.3	Materials used.....	9	9.2	Warranty and maintenance.....	37
<b>3</b>	<b>Installation.....</b>	<b>10</b>	<b>10</b>	<b>Technical data.....</b>	<b>38</b>
3.1	Conditions.....	10	10.1	Installation dimensions.....	39
3.2	Installation of the rotary flange fitting.....	10	10.2	Connection options.....	39
3.3	Installation of the device.....	11	10.3	Accessories.....	40
3.4	Draining of the backwash water..	12	10.4	Electronic control unit.....	41
3.5	Commissioning.....	14	10.5	Spare parts.....	43
<b>4</b>	<b>Operation backwash protective filter.....</b>	<b>14</b>	<b>11</b>	<b>Disposal.....</b>	<b>45</b>
4.1	Cleaning of the sieve insert (backwashing).....	14	<b>12</b>	<b>EC Conformity Declaration.....</b>	<b>46</b>
4.2	Conversions, changes.....	15	<b>13</b>	<b>Maintenance log.....</b>	<b>47</b>
4.3	Maintenance, repair, spare parts	15	<b>14</b>	<b>Customer service.....</b>	<b>48</b>
4.4	Temporary removal of the device.....	15			
<b>5</b>	<b>Operation microleakage protection system.....</b>	<b>16</b>			
5.1	Control panel.....	16			
5.2	Possible settings.....	16			
5.3	Factory settings.....	17			
5.4	<i>Menu</i> key - selectable functions and settings.....	18			
5.5	Setting limit values.....	24			
5.6	Automatic operation.....	26			
5.7	Automatic shut-off of the water supply.....	26			
5.8	Special control mode.....	27			
5.9	Emergency-open function.....	28			

# 1 Safety

These operating instructions must always be available at the place of use of the device.

## 1.1 Intended use

The device is for the

- Filtration

of drinking water in domestic water piping and for commercial and industrial use. It removes coarse and fine-grained particles from the drinking water, which are larger or equal to the mesh size of the filter, in order to prevent

- pipe damage caused by corrosion
- malfunctions of fittings or control and regulating devices caused by foreign bodies.

The device can be installed in all commercially available drinking water pipes. Both installation and use of the device are subject to the applicable national regulations.

**i** Particles that are smaller than the mesh size of the filter supplied and materials causing cloudiness cannot be filtered out of the water.

## Leakage protection system

The device is intended to shut off the water supply to drinking water systems, upon exceeding of the settable values for

- maximum withdrawal time
- maximum water quantity
- maximum water volume flow

for protection against water damage, water loss and unwanted water consumption.

## 1.2 Application limits

### 1.2.1 Water quality

The water to be filtered must comply with the European Drinking Water Directive (98/83/EC). Before using the device with water that does not comply with this Directive, it is essential to consult the manufacturer.

### 1.2.2 Water pressure



#### CAUTION

The water pressure must not exceed 10 bar input pressure. The device must not be installed if the mains pressure is above 10 bar (even for a short time)!

Nominal pressure	PN 10
Operating pressure	1.5 bar - 10 bar

The water pressure must not fall below 1.5 bar as otherwise backwashing can be impaired!

### 1.2.3 Water and ambient temperature

The filter is suitable for use in cold drinking water up to a maximum water and ambient temperature of 30 °C.

## 1.3 Safety instructions



#### DANGER!

**The appliance contains magnets. The magnetic radiation emitted from it can cause pacemakers or implanted defibrillators to stop working. This can lead to severe impairment or even death.**

**Affected persons must therefore keep a safe distance of at least 0.5 m from the appliance.**

**DANGER**

The device could reduce or cut water supply for equipment downstream requiring constant readiness for water withdrawal (e.g. thermal flow protection, sprinkler system).

This could result in fires or explosions.

If there are downstream safety devices and the water supply line to these devices does not branch off upstream of the device, then the device must not be installed!

**DANGER**

The motorised ball valve is installed on the rear side of the device. When the device is not installed, the ball valve can be reached with the finger through the opening on the rear.

If the device is commissioned or connected to the mains without being installed, there is a risk of crushing due to rotating parts.

Never operate the device or connect it to the electrical mains if it is not fully installed!

Never put your finger in the opening on the rear side of the device!

**1.3.1 Electrical danger****Risk of electric shock**

No electrical wiring or equipment that is not splash-proof may run or be stored below the device. Electrical devices/equipment located in the vicinity of the device must be splash-proof or comply with the legal regulations for wet rooms.

Only the supplied power supply unit may be used to connect the unit to the power

supply. This reduces the mains voltage for operating the electronics to a harmless low voltage of 24 V.

A splash-proof socket above the device, at a distance of no more than 1.5 m, is required for connection to the mains, in accordance with the legal regulations for wet rooms.

The power supply unit must be disconnected to make the electrical installation.

**1.3.2 Warning of property damage****WARNING**

Risk of water damage or damage to property

The device may only be installed by qualified technical personnel.

The installation room must be dry and free from frost.

The ambient temperature must not exceed 30 °C! In higher temperatures or direct sunlight, material damage may occur up to and including breakage of device parts.

An adequately sized wastewater connection (e.g. floor drain) in compliance with DIN 1986 must be provided.

In order to ensure safe drinking water hygiene, a free discharge of the wastewater acc. to DIN EN 1717 must be ensured.

The pipe must be able to safely support the device (weight: see chapter 10). If necessary, the pipes must be provided with additional fastenings or support.

If no bypass valve is installed, a shut-off valve must be installed upstream and downstream of the device in order to interrupt the water supply during installation, maintenance, repair or malfunction of the device.

Install the device in a vertical position ( $\pm 5^\circ$ ); the connection for waste water from backwashing must be directed downwards. Otherwise, water may escape and cause water damage.

For the installation of the device in domestic water piping, only use the supplied built-in rotary flange (see chapter (siehe Kapitel 3.2).

The flange surface of the rotary flange fitting must be upright!

The rotary flange fitting must be fitted so that it is free from mechanical stress or strain. Otherwise mechanical damage to the pipe or the rotary flange fitting up to and including breaks can result.

For proper sealing the profile of the profile flange seal must point towards the rotary flange fitting (siehe Figure 2).

Only operate the device in a technically faultless condition:

- Check for damage prior to installation.
- Immediately have any malfunctions in operation rectified by qualified technical personnel.

The appliance must not be exposed to strong vibrations.

The mains voltage must not be interrupted (e.g. via a light switch). If the device is not permanently supplied with power,

- a possible leakage cannot be detected.
- the leakage protection cannot close in the event of a leakage.

Persons who, due to their physical, sensory or mental abilities or their inexperience or lack of knowledge, are unable to operate the device safely may not operate it without supervision or instruction from a responsible person.

Regular backwashing of the device is required to ensure safe drinking water hygiene (see chapter 4.1.1).

Before carrying out a backwash, ensure that the wastewater connection is functional.

At the end of the backwashing process, turn the handwheel until it engages so that no more backwash water escapes. Otherwise, water may constantly escape and cause water damage.

After the leakage protection has closed due to a limit being exceeded, first check whether there is a leak before opening the leakage protection again.

If there is a device for hot water preparation (in particular a gas or electrically operated instantaneous water heater or a heating boiler), the manufacturer's instructions for the water heater must be observed before opening the leakage protection (instructions for venting).

Do not use household cleaning agents to clean the outside of the device, but only use clear water to avoid embrittlement of the plastic.

The device may only be repaired by qualified technical personnel.

Only use original spare parts for repairs.

Before performing work on the device that goes beyond pure operational use, the device must be depressurised! If this is ignored, the result may be uncontrolled escape of water resulting in water damage to the building/home.





If the device is removed due to an interruption of operation:

- Protect the flange surfaces against damage to ensure proper sealing.
- Protect the device from dirt so as not to impair drinking water hygiene.
- Store the device in a frost-free place to prevent damage caused by freezing water and leakage.

**Unauthorised conversions and changes are forbidden for safety reasons. These can impair the functioning of the device, leading to leaks and, in the worse case scenario, to bursting of the device.**

## 1.4 Symbols used

The safety instructions contained in these operating instructions are labelled with the following symbols:

	Indication of existing dangers
	Warning of electric voltage
	Torques specified by the manufacturer
	User tips and other information

Instructions attached directly to the device, e.g.:

- Direction of flow (arrow)
- Type label
- Cleaning information

must be observed and maintained in legible condition.

## 1.5 Units used

Unit	Conversion
bar	1 bar = $10^5$ Pa = 0.1 N/mm <sup>2</sup>
¾"	DN 20
1"	DN 25
1¼"	DN 32

## 1.6 Normative basics

This device has been designed and manufactured according to

- DIN 3553 (Leakage protection systems with sensors and automated shut-off devices, requirements and tests)
- DIN 19628 (Mechanical filters in drinking water stations - Application of mechanical filters according to DIN EN 13443-1)
- DIN EN 13443-1 (Systems for the treatment of drinking water within buildings - Mechanical filters - Part 1: Filter fineness 80 µm to 150 µm - Requirements for design, safety and testing; German version)

## 2 Product information

### 2.1 Scope of supply

### 2.2 Function description

Subsequently the filtered water exits the device again via the rotary flange fitting.

### Leakage protection system

The device measures the water flow and monitors the set limit values for water withdrawal. Water flow is shut off if limit values are exceeded.

Monitored limit values:

- maximum water quantity in litres
- maximum water flow in litres per hour
- maximum water withdrawal time in minutes

These limit values

- are automatically determined and set in a learning mode phase during the flow of the first 10 m<sup>3</sup> of water.
- can also be modified via the menu.

 The teach-in mode can be restarted at any moment when requested.

To ensure fault-free operation, the leakage protection system is equipped with automatic mechanisms that prevent faults.

### Sleep mode

Limit value monitoring can be deactivated during a pre-set time to allow transport of large water volumes (for garden irrigation, filling pools etc.).

### Vacation mode

During longer absences, the limit values can be easily reduced or the water supply can be completely shut off.

### Micro leakage testing

Micro leakage testing can be performed to detect leaks in the water pipe system even if they are very small.

### Remote monitoring and control

The device can be integrated in building control systems (see chapter 6).

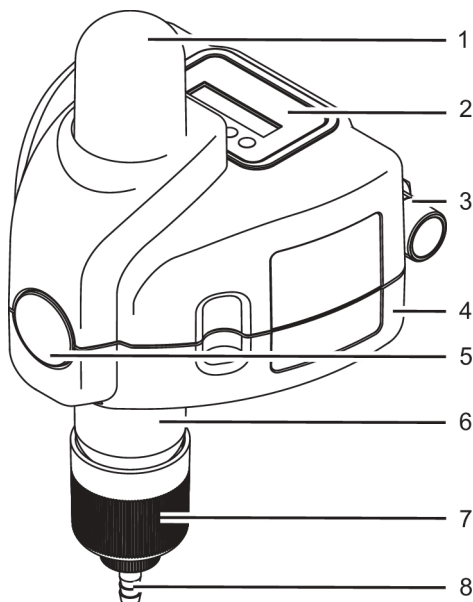

Fig. 1: Functional description

- 1 Limescale prevention unit
- 2 Control panel of the micro-leakage protection system
- 3 Rotary flange fitting
- 4 Insulating shell set
- 5 Pressure gauge
- 6 Transparent filter bowl
- 7 Handwheel for backwashing
- 8 Outlet for waste water from backwashing



## **2.3 Materials used**

The materials and substances used are resistant to the physical, chemical and corrosive loads expected to be encountered in drinking water.

The materials and substances in contact with drinking water fulfill the requirements of §17 of the German Drinking Water Ordinance, which are available in concretised form in the current assessment bases and guidelines of the Umweltbundesamt (German Federal Environment Agency).

### 3 Installation



#### CAUTION

The device may only be installed by qualified technical personnel.

Installation of the device upstream of the water meter is forbidden.

#### 3.1 Conditions



#### CAUTION

**Risk of property damage or water damage!**

The pipe must be able to safely support the device (weight: see chapter 10). If necessary, the pipes must be provided with additional fastenings or support.

To ensure convenient operation and maintenance of the device, always adhere to the specified clearances in chapter 3.4.1.

##### 3.1.1 Requirements for the place of installation



#### CAUTION

The installation room must be dry and free from frost.

The ambient temperature must not exceed 30 °C! In higher temperatures or direct sunlight, material damage may occur up to and including breakage of device parts.

An adequately sized waste water connection (e.g. floor drain) in compliance with DIN 1986 must be provided.

### 3.2 Installation of the rotary flange fitting



#### CAUTION

The flange surface of the rotary flange fitting must be upright!

The rotary flange fitting must be fitted so that it is free from mechanical stress or strain. Otherwise mechanical damage to the pipe or the rotary flange fitting up to and including breaks can result.

The built-in rotary flange serves as a connecting element between the domestic water installation and the device. It is suitable both for horizontal and vertical pipes.

**Attention:** Install the built-in rotary flange in the flow direction! This is indicated by an arrow integral with the casting.



If the installation is twisted, back-washing the device is not possible.

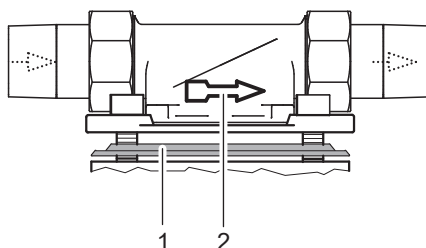

Fig. 2: Rotary flange fitting

- 1 Profile flange seal
- 2 Flow direction arrow

### 3.3 Installation of the device



#### CAUTION

If no bypass valve is installed, a shut-off valve must be installed upstream and downstream of the unit in order to interrupt the water supply during installation, maintenance, repair or malfunction of the device.

Install the device in a vertical position ( $\pm 5^\circ$ ); the connection for waste water from backwashing must be directed downwards. Otherwise, water may escape and cause water damage.

For the installation of the device in domestic water piping, only use the supplied built-in rotary flange (see chapter 3.2).

The flange surface of the rotary flange fitting must be upright!

For proper sealing the profile of the profile flange seal must point towards the rotary flange fitting (see Figure 2: Rotary flange fitting, page 10).

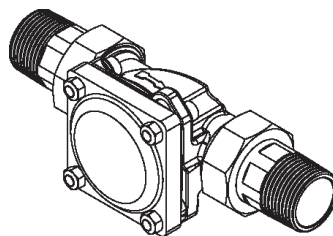

Fig. 4: Connection of appliance engaged

#### Do not undo the screws of the device!

1. Insert the heads of the four flange screws through the bayonet holes on the rotary flange fitting (see Figure 3).
2. Turn the appliance in clockwise direction up to the stop (see Figure 3 and Figure 4).
3. Tighten the four flange screws.



Select the tightening torque (approx. 4 Nm) so that the seal is effective and the device is not damaged or strained!

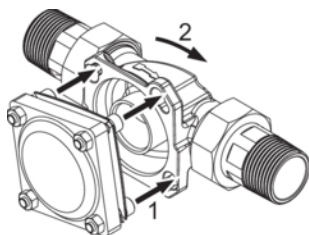

Fig. 3: Attach and engage appliance

- 1 Insert screws
- 2 Turn clockwise to engage screws

### 3.4 Draining of the backwash water



#### CAUTION

An adequately sized waste water connection (e.g. floor drain) in compliance with DIN 1986 must be provided.

**In order to ensure safe drinking water hygiene, a free discharge of the waste water acc. to DIN EN 1717 must be ensured.**

The drain must be large enough so that all of the wastewater can be drained simultaneously.

If a wastewater connection directly beneath the device is not possible, the backwash water can be drained away via a hose or a pipe that is connected from the backwashing water valve over a few meters to the closest wastewater connection. The dimensioning of this pipe must correspond to the backwashing water valve.

If a bucket is used to drain off the backwash water:

- **Attention:** If the mains pressure is high, water may spray out of the bucket. Protect objects near the bucket from water damage!
- Carry out the backwashing quickly and finish the backwashing process as soon as the bucket is half full. Otherwise the bucket could overflow.

### 3.4.1 Drainage options for the backwash water

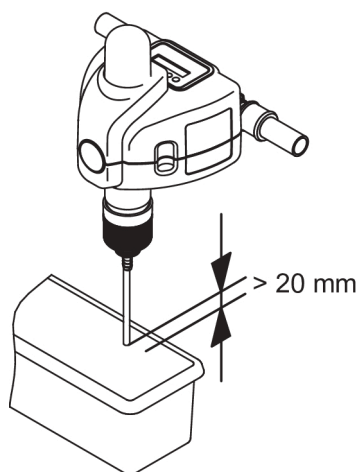
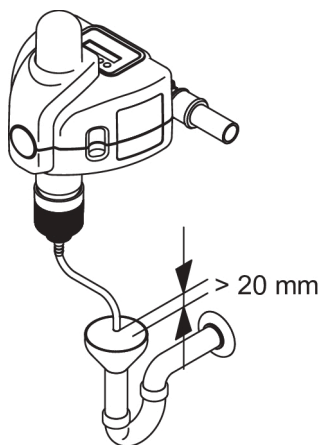
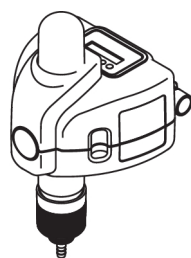
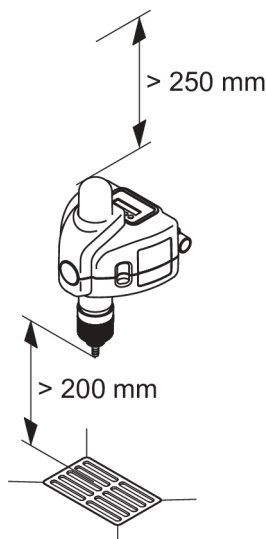

### 3.5 Commissioning

Prior to initial commissioning (or to commissioning after maintenance work) fill the installed device with water and vent:

1. Open the upstream shut-off valve to fill the device with water. The device is now under mains pressure.
2. **Attention:** Carry out a backwashing immediately so that the trapped air can escape (see chapter 4.1.2)! This prevents damage to the installation by water hammer pressure surges.

→ After backwashing, the device is vented and ready for operation.

## 4 Operation backwash protective filter

### 4.1 Cleaning of the sieve insert (backwashing)

A regular cleaning process is necessary to remove the residues from the sieve fabric of the device. This process is called **backwashing**.

Suction pipes are provided for backwashing, which rotate around the sieve fabric of the fine filter. The backwashing valve opens on the bottom side of the device. By reversing the water flow from inside to outside, deposits on the sieve fabric are carried away and rinsed out with the backwash water. The suction pipes also clean the inside of the transparent filter bowl with wiper lips during their movement.

The degree of contamination and cleaning process can be observed from the outside.



The device is backwashed with filtered water. The filtered water supply of the domestic installation remains intact during the backwashing process. No dirty water can reach the pure water side during the backwashing.

### 4.1.1 Backwashing interval

If cleaning is not performed soon enough, the result may be damage to the sieve insert. Large quantities of filtered particles can deform the sieve fabric and in extreme case lead to tearing of the sieve fabric. In addition, larger deposit quantities can impair the backwashing function mechanically.

According to DIN EN 13443-1 backwashing the device is required at the latest every six months.

**The manufacturer recommends a backwashing:**

- at least every 2 months
- if the water pressure drops
- if the filter is visibly dirty

Experience has shown that new installations in the early stages of installation lead to increased dirt deposits. In this case, a more frequent backwashing is necessary.

## 4.1.2 Backwashing



### WARNING

Persons who, due to their physical, sensory or mental abilities or their inexperience or lack of knowledge, are unable to operate the device safely may not operate it without supervision or instruction from a responsible person.

Before carrying out a backwash, ensure that the wastewater connection is functional.

At the end of the backwashing process, turn the handwheel until it engages so that no more backwash water escapes. Otherwise, water may constantly escape and cause water damage.

1. Turn handwheel left up to stop. **Backwashing water escapes.**
  2. Turn handwheel right up to stop. Ensure that no water escapes.
- The backwashing process is completed (see chapter 4.1).

## 4.2 Conversions, changes



### WARNING

Unauthorised conversions and changes are forbidden for safety reasons. These can impair the functioning of the device, leading to leaks and, in the worse case scenario, to bursting of the device.

## 4.3 Maintenance, repair, spare parts



### CAUTION

The device may only be repaired by qualified technical personnel.

Only use original spare parts for repairs.

Before performing work on the device that goes beyond pure operational use, the device must be depressurised! If this is ignored, the result may be uncontrolled egress of water resulting in water damage to the building/home.

## 4.4 Temporary removal of the device



### WARNING

If the device is removed due to an interruption of operation:

- Protect the flange surfaces against damage to ensure proper sealing.
- Protect the device from dirt so as not to impair drinking water hygiene.
- Store the device in a frost-free place to prevent damage caused by freezing water and leakage.

When recommissioning the device, proceed as with a new installation.

## 5 Operation microleakage protection system

### 5.1 Control panel

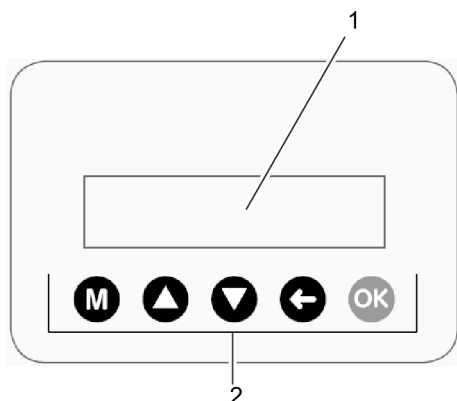

Fig. 5: Leakage protection control panel

- 1 Two line display  
2 Keyboard

The leakage protection unit is operated via the keyboard.

Functions of the individual keys:

	<b>Menu key</b> - Access to the <i>Setting</i> menu
	<b>Arrow key</b> - Scroll up in the menu - Increase value
	<b>Arrow key</b> - Scroll down in the menu - Reduce value
	<b>Back key</b> - Jump one menu level back without saving

	<b>OK key</b> - Access to the sub-menu - Accept value and save, then jump one menu level back - Acknowledge message
--	--

### Meaning of the display's background lighting:

None:	Operating state without water flow
Blue flashing light:	Operating state with water flow
White:	upon pressing of a key
Yellow:	for warning messages
Red:	for fault indications

### 5.2 Possible settings

The following settings can be made via the key *Menu* (Selection Setting):

Submenu item	Setting
Language	German, English, French, Dutch, Italian
Leakage protection (see chapter 5.5)	Limit values Vacation mode Sleepmode time Auto. testing (micro leakage testing)
Date	Day / month / year
Time	Hours / minutes
Backlight	10 % to 100 %, in 10% steps
Contrast	10 % to 100 %, in 10% steps
Tone	Off / on / interval 6 h
Message relay	Set fault indication relay as normally closed contact / normally open contact



Submenu item	Setting
Factory setting	Recreate factory setting; see chapter 5.3)

**Procedure:**

1. Press *Menu* key.
2. Navigate to *Setting* using the arrow keys and confirm with the *OK* key.
3. Navigate to the desired setting (e.g. date) and confirm with the *OK* key.
4. Using the arrow keys navigate to the desired setting (e.g. set date) and confirm with the *OK* key.

**5.3 Factory settings**

The device is set as follows when delivered:

Setting for:	Set to:
Language	English
Leakage protect - limit value for maximum withdrawn time	30 min
Leakage protect - limit value for max. water flow	4000 L/h
Leakage protect - limit value for maximum water quantity	500 L
Leakage protect - vacation mode	Vacation mode on, U1
Leakage protect - Sleepmode time	6 h
Leakage protect - Auto testing (micro leakage testing)	Auto testing off
Backlight	80 %
Contrast	50%
Tone - leakage warning	on
Tone - fault	6 h
Message relay	Normally closed



Upon resetting to the factory settings, the above mentioned settings are recreated.

### 5.3.1 Resetting to factory setting

All settings that have been made can be reset to the factory setting as follows:

1. Press *MENU* key.
2. Using the arrow keys navigate to the *Setting* menu item and press OK.
3. Using the arrow keys navigate to the *Factory setting* menu item and press OK.
4. Using the arrow keys select the following setting and confirm with the OK key:

Factory setting  
 <yes>

→ The standard settings are recreated (see chapter 5.3).

### 5.4 Menu key - selectable functions and settings



The following can be selected or set via the menu key:

- Close (manually close leakage protection)
- Sleep mode (pause limit value monitoring for a specified time)
- Vacation mode (limit values can be easily reduced or the water supply can be completely shut off)
- Micro leakage testing
- Learn mode (determine limit values from water flow)
- Settings (see chapter 5.2)
- Operating data
- Info

#### Procedure:

1. Press the menu key, to call the main menu.

Main menue  
 Language

2. Use the keys ▲ and ▼ to navigate through the sub-menu. Confirm the desired sub-menu item with the **OK** key.
3. Then use the keys ▲ or ▼ to select the desired setting and confirm with the **OK** button.

→ The desired setting is saved.

### 5.4.1 Menu structure

#### Micro-leakage protection system

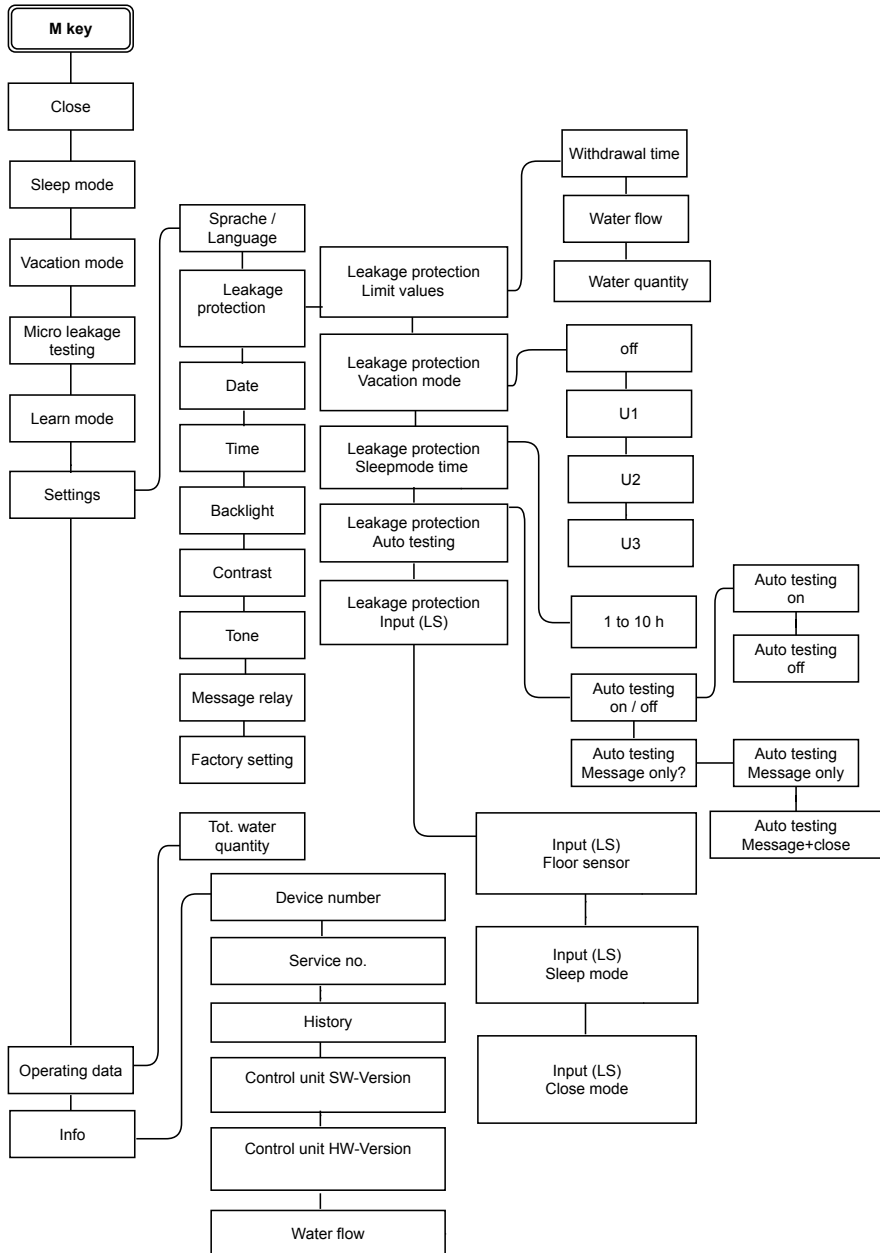

## 5.4.2 Manually close or open leakage protection

### Close leakage protection:

1. Press *Menu* key.
2. Using the arrow keys, select menu item *Close* and press key *OK*. The following appears on the display:

Leakage protect  
close <OK>

3. Press *OK* to confirm. The following appears on the display in an alternating manner (with a yellow background):

Leakage protect  
closed

To open  
press <OK>

→ Water supply is shut off by the leakage protection system.



The *Menu* key is deactivated in this state.

### To open the leakage protection system:

- Press *OK* key.

→ The leakage protection system opens for water supply. The default status display appears.

## 5.4.3 Temporary deactivation of the leakage protection (sleep-mode)

Situations in which large water volumes are required on a one-off basis, e.g.

- Watering the garden
- Filling the swimming pool
- Filling the garden pond

may require the switching off of limit value monitoring. This is referred to as "Sleep mode".



No monitoring of water consumption takes place in sleep mode.

### Activation of sleep mode:

1. Press *Menu* key.
2. Select *sleep mode* using the arrow keys and confirm with the *OK* key. The following appears on the display:

Start  
sleep mode <OK>

3. Press *OK* to confirm.

→ Sleep mode starts. The following appears on the display in an alternating manner (with a yellow background):

Leakage protect.  
6 hours off

To end  
press <OK>

The countdown of the displayed sleep mode time runs. During this time, limit value monitoring is paused.



The default sleep mode time of 6 h can be changed in hour steps to another value in the range 1 to 10 h.

After the sleep mode time has elapsed, limit value monitoring starts again and the default status display appears.

The *Menu* key is deactivated in sleep mode.

Vacation mode  
Start <OK>

3. Press *OK* to confirm.

→ Vacation mode is activated. The following appears on the display in an alternating manner (with a yellow background):

Leakage protect.  
in vacation mode

To end  
press <OK>

### Cancel sleep mode:

- Press *OK* key.

→ Normal limit value monitoring starts again. The default status display appears.

## 5.4.4 Activation of vacation mode

During longer absences, the limit values for water withdrawal can be reduced or the water supply can be completely shut off.

There are two possibilities:

- immediate manual activation
- automatic activation after approx. 72 hours without water flow



Vacation mode remains active until key *OK* is pressed (the vacation mode message then disappears).

Key *Menu* is deactivated during vacation mode.

### I. Immediate activation of vacation mode (manual)

1. Press *Menu* key.
2. Select *Vacation mode* using the arrow keys and confirm with the *OK* key. The following appears on the display:

## II. Setting vacation mode automatic activation

There are four different settings for automatic activation:

- off (no automatic activation of vacation mode)
- U1 (= limit values 500 L/h • 50 L • 5 min)
- U2 (= limit values 1000 L/h • 100 L • 10 min)
- U3 (= shut-off valve closed - no water flow)

1. Press *Menu* key.
2. Navigate to *Setting* using the arrow keys and confirm with the *OK* key.
3. Navigate to *Leakage protection* using the arrow keys and confirm with the *OK* key.
4. Navigate to *Vacation mode Leakage protection* using the arrow keys and

confirm with the **OK** key.

5. Select die desired setting (off • U1 • U2 • U3) using the arrow keys and confirm with the **OK** key.

→ The selected vacation mode is saved.

#### To terminate vacation mode:

- Press **OK** key.

→ Vacation mode is terminated. Normal limit value monitoring starts again. The default status display appears.

### 5.4.5 Micro leakage testing, manual or automatic

The device also has the option of being able to promptly detect small leaks.

Micro leakage testing can be started manually at any time (see Starting micro leakage testing manually, page 23), but can also take place automatically (see Performing micro leakage testing automatically, page 22).

If the leak cannot be found, even though a micro leakage is repeatedly detected, the installer or a professional company should carry out a leak detection on the installation, in order to find any possible leaks.



Automatic micro leakage testing is deactivated upon delivery and can be activated if desired.

If automatic micro leakage testing is activated with subsequent setting to message and closing of the water supply, it is possible that frequent shutting off of the water supply can occur because, based on experience, very small leaks are not an infrequent occurrence.

A preceding period of at least one hour without any water flow is necessary so that a micro leakage test can run.

### Performing micro leakage testing automatically

Micro leakage testing can also be performed automatically; in this case testing is performed daily without anything further to do.

#### The following setting is necessary for this:

1. Press the *menu* key.
2. Select *Setting* using the arrow keys and confirm with the **OK** key.

```
Main menue
• Setting
```

3. Select *Leakage protect* using the arrow keys and confirm with the **OK** key.

```
Setting
Leakage protect
```

4. Select *Auto. testing* using the arrow keys and confirm with the **OK** key.

```
Leakage protect
Auto. testing
```

- Using the arrow keys select *on* or *off*, to activate or deactivate automatic micro leakage testing. Save the selected setting with the **OK** key.

```
Auto. testing
• on
```

```
Auto. testing
• off
```

→ The selected setting is saved.

Possible settings for automatic micro leakage testing

**The following settings can be selected for the occurrence of a micro leakage that has been detected via automatic micro leakage testing:**

- Micro leakage message on the display
- Micro leakage message on the display and additional shutting off of the water supply

- Press the Main menu key.
- Select *Setting* using the arrow keys and confirm with the **OK** key.

```
Main menue
• Setting
```

- Select *Leakage protect* using the arrow keys and confirm with the **OK** key.

```
Setting
Leakage protect
```

- Select *Auto testing* using the arrow keys and confirm with the **OK** key.

```
Leakage protect
• Auto testing
```

- Select *Message only?* using the arrow keys and confirm with the **OK** key.

```
Auto testing
• Message only?
```

- Select the desired setting using the arrow keys and confirm with the **OK** key:

```
Auto testing
Message only
```

```
Auto testing
Message+close
```

→ The selected setting is saved.

## Starting micro leakage testing manually

**Prerequisite:** all water withdrawal points must be closed during micro leakage testing.

- Press *Menu* key.
- Select *Leakage protection* using the arrow keys and confirm with the **OK** key.

```
Main menue
• Leakage protect
```

- Select *micro leakage* using the arrow keys and confirm with the **OK** key.

Leakage protect  
• Micro leakage  
testing

→ Micro leakage testing starts.

**If no micro leakage has been detected**, the display alternates between

No leakage  
occurred

To acknowledge  
press <OK>

→ The display returns to the operating display.

**If no micro leakage has been detected**, the display alternates between

Small leakage  
occurred

To acknowledge  
press <OK>

→ The display returns to the operating display.



Micro leakage testing can be started manually at any time even when a regular automatic test had been set.

Prerequisite for automatically running micro leakage testing is a period of at least one hour, in which no water withdrawal takes place.

## 5.5 Setting limit values

Exceeding of the set limit values for

- maximum water quantity
- maximum water flow
- maximum water withdrawal time

leads to shutting off of the water supply.



When setting the limit values, consideration must be given to devices that depend on a sometimes very low continuous water supply over a long period of time to ensure their proper functioning (e.g. certain tumble dryers, etc.).

It is also possible to operate such devices using sleep mode of the micro leakage protection system.



### 5.5.1 Factory setting

The table shows the factory set limit values at which the device shuts off the water supply:

Shut-off criterion	Value / unit
Maximum water quantity (uninterrupted)	500 litres (L)
Maximum water flow (uninterrupted)	4000 litres per hour (L/h)
Maximum water withdrawal time	30 minutes (min)

Table 1: Factory-set limit values

If desired, allow adjustment of the limit values in two different manners:

- Manual (see chapter 5.5.2)
- Via learning mode (see chapter 5.5.3).

### 5.5.2 Changing limit values manually

#### Procedure:

1. Press *Menu* key.
2. Navigate to *Setting* using the arrow keys and confirm with the *OK* key.
3. Navigate to *Leakage protection* using the arrow keys and confirm with the *OK* key.
4. Navigate to *Leakage protect/limit values* using the arrow keys and confirm with the *OK* key.

Then the individual shut-off criteria can be selected and set to the desired value inside the ranges specified in the table (select via arrow key, confirm with *OK*).

Shut-off criterion	Setting range	Step size
Max. withdrawal time	10 min to 10 h, unlimited	10 min
Max. water flow	500 to 5000 L/h, unlimited	500 L/h
Max. water quantity	100 to 3000 L, unlimited	100 L

Table 2: Adjustment ranges of the limit values

### 5.5.3 Determine and set limit values automatically: Learn mode

Reasonable limit value settings corresponding to the individual water consumption are calculated and saved from the factory limit settings and the water withdrawals during the first 10 m<sup>3</sup> of water flow.



The learning mode phase is indicated by *L10* at the end of the second line of the display.

The value after the *L* indicates how many m<sup>3</sup> water flow are still outstanding before learning mode will be complete.

#### Starting learning mode:

1. Press *Menu* key.
2. Navigate to *learning mode* using the arrow keys and press *OK* key.

→ Learning mode starts

During learning mode, the following are output to the display in alternation:

Learning mode  
is terminated

New limit values  
Accept <OK>

- Confirm the display with **OK**, if the limit values determined in learning mode are to be applied.

New limit values  
Ignore <OK>

- Confirm the display with **OK**, if the limit values determined in learning mode are **not** to be applied. In this case, the currently set limit values are then retained.



Monitoring of the limit values also takes place during the learning mode phase, based on the limit values that are actually set.

Exceeding of the set limit value or a possibly active vacation mode has no influence on the determination of the limit values by learning mode.

Learning mode can subsequently be repeated at any time, e.g. if an exceptionally high water withdrawal has taken place during the learning phase.

## 5.6 Automatic operation

Water consumption is continuously monitored. If during drawing of water one of these limits is exceeded, the device shut-off valve closes.

## 5.7 Automatic shut-off of the water supply



### CAUTION

After the leakage protection has closed due to a limit being exceeded, first check whether there is a leak before opening the leakage protection again.

If there is a device for hot water preparation (in particular a gas or electrically operated instantaneous water heater or a heating boiler), the manufacturer's instructions for the water heater must be observed before opening the leakage protection (instructions for venting).

If one of the set limit values has been exceeded, the water supply is shut off and the display shows the type of the limit value overshoot:

Leakage protect  
closed

Water quantity  
exceeded

or

Water flow  
exceeded

or

Withdrawal time  
exceeded

To open  
press <OK>

## 5.8 Special control mode

The device enables the assigning of separate limit value settings to periods when water consumption is regularly lower (e.g. at night or possibly also at weekends). This allows even more effective limiting of the extent of water damage in the event of a leak.

**i** It is only possible to adjust special control mode via the JU-Control App (see chapter 6.2 Control via app, page 30).

**Prerequisite for operating the device via app is the installation of the connectivity module available as an accessory (see chapter 10.3).**

Up to seven special control time periods can be set.

### Adjusting special control:

1. In the JU-Control App select the device and open the *device menu*.
2. Select *Setting*.



3. Select *Time limit value special rule* and add.



→ The first time adjustment range for special control mode appears:

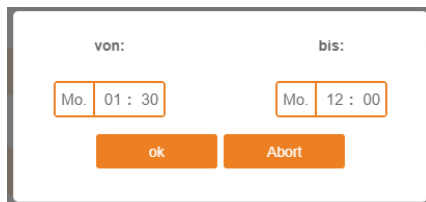

4. In the corresponding fields, set date and time for the start and end of the special rule and confirm with **OK**.  
Example:



5. Select *special rule limit values*.  
→ The display for setting the limit values for the special rule range appears.



Enter the desired values in the limit value fields.

**i** The set special rule limit values apply to all special rule time periods.

**6. Confirm the set special rule with OK.**

→ The special rule has now been saved and is transferred to the device control. The JU-Control App can be closed.

**i** The limit values are monitored via the device control, independently of the Internet connection.

If a special rule is active, an "S" appears at the end of the 2nd line on the device's display.

## 5.9 Emergency-open function

The leakage protection shut-off valve can be opened and shut without power supply (e.g. in case of power failure during a building fire). This is particularly important when fire-fighting water is required.

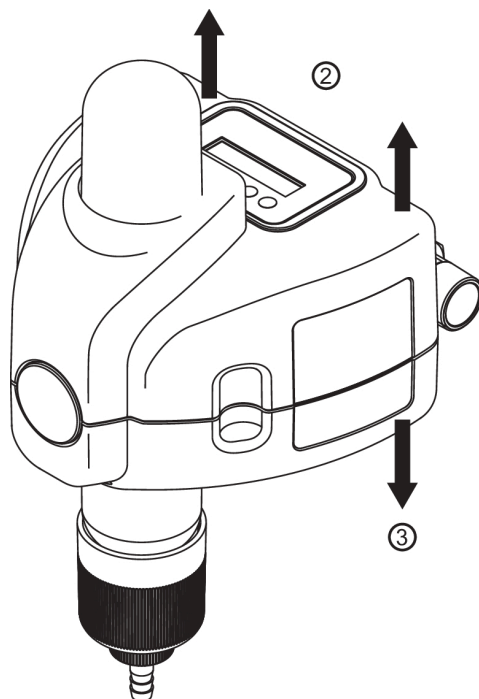

Fig. 6: Removing the casing

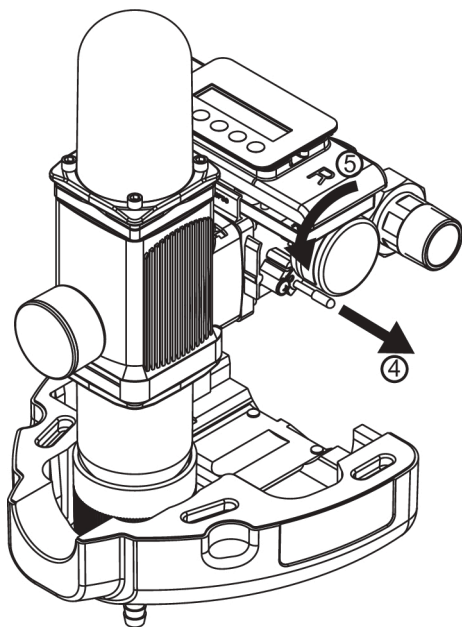

Fig. 7: Remove the red locking pin and rotate the motor

#### Open the shut-off valve manually as follows:

1. Unplug the power supply unit.
2. Take off the upper cover in an upwards direction (see Figure 6).
3. Push the lower cover downwards (see Figure 6).
4. Remove the red locking pin (see Figure 7).
5. Turn the motor **counter-clockwise** through approximately 90 degrees ( $\frac{1}{4}$  of a turn; see Figure 7). It is not necessary to release any screws to do this.

→ The shut-off valve is opened.

For recommissioning perform the reverse sequence.

## 5.10 Displaying operating data and information

### How to display the total water volume since commissioning:

1. Press *Menu* key.
2. Navigate to *Operating data* using the arrow and confirm with the *OK* key.

The following appears on the display:

Total  
water volume

3. Press *OK* to confirm.

→ The water volume that has flowed through since commissioning is displayed.

The following information about the device can be called up via the *Menu* key and the *Info* menu item:

- Type of limit value overshoot
- Device type
- Device ID
- Software version of the device control
- Measured values (actual water flow)
- Service department telephone number (+49 7195 692-0)
- Manufacturer
- History (events with date)

## 6 Remote control and Remote transmission of messages



**The device may only be installed by qualified technical personnel.**

**The power supply unit must be disconnected to make the electrical installation.**

The leakage protection system offers the following options:

- Connection with building control systems for forwarding of status or fault indications (see chapter 6.1.2)

### 6.1 External messages

The device has a potential-free output via which leakage protection messages and fault messages can be transmitted potential-free to a peripheral device.

#### 6.1.1 Setting the message relay

1. Press the *Menu* key.
2. Select *Settings* using the arrow keys and confirm with *OK*.
3. Using the arrow keys select setting *Normally open* or *Normally closed* (see Figure 0, page 42). The display shows:

Message relay  
Normally open

In this setting, the message relay has closer function, i. e. the relay is energised during a fault.

Message relay  
Normally closed

In this setting, the message relay has opener function, i. e. the relay drops out during a fault.

4. Confirm the desired setting with *OK*.

→ The setting is saved. The standard operating indication reappears on the display.

#### 6.1.2 Integration in building control systems

The leakage protection system can be integrated into a building control system (e.g. EIB / KNX, LCN or LON) via the floating signal relay.

The potential-free relay is connected to a binary bus coupler.

In this way, fault messages can be forwarded to the building control system.

### 6.2 Control via app

***i* Prerequisite for operating the device via app is the installation of the connectivity module available as an accessory (see chapter 10.3).**

With the JU-Control app you can

- close water supply
- activate sleep mode
- activate vacation mode
- start micro leakage testing
- display water consumption graphs
- execute settings (e.g. limit value settings)
- call up information on the operating state
- set and/or call up maintenance reminders

Requirement for remote control of the leakage protection via mobile devices (tablet, smartphone, etc.):

- Stable Internet connection of the device at the place of installation (see section **I. LAN cable connection / connection device - internet**)
- Download of the JU-Control App to the mobile device (see section **II. Download and set up the JU-Control App**)
- Linking of the device with the user account via the JU-Control App (see section **III. Link device with user account**)

Connecting of the leakage protection system to the router (internet) is possible in the following ways:

- via LAN cable
- via PowerLAN (power line) module
- via WiFi, by using WiFi repeater with additional LAN output, into which the LAN cable connected to the device is plugged in

**i** The necessary components for creating the network connection are not supplied. If necessary, they can be sourced from a specialist electrical dealer.

## **I. LAN cable connection / connection device - internet**

### **Procedure:**

1. Disconnect the power supply unit from the mains supply.
  2. Plug the LAN cable into the LAN port of the connectivity module on the underside of the device.
  3. Plug the power supply unit back in.
- The device automatically connects to the JUDO server.

**i** The connection is TLS-encrypted to ensure secure data transfer.

The home network router must be configured so that internal IP addresses are automatically allocated via DHCP. In general this is the factory setting.

## **II. Download and set up the JU-Control App**

Availability:

- Free of charge in the Google Play Store (Android) or App Store (iOS)

Necessary actions after download and starting of the JU-Control App

- Create user account (also possible in advance via <https://ju-control.app>)
- Accepting the data protection declaration
- Click on the confirmation link in the E-mail that is received.
- in the app: Create location (location name and optional specification of town, street) and save

## **III. Link device with user account**

To operate the device via the JU-Control App, the device previously connected to the Internet must still be linked to the user account via the JU-Control App.

### **Procedure:**

1. After defining the location, select the *Add device* button.
2. Use the QR code scanner integrated in the JU-Control App to scan the QR code on the side of the device casing.

**i** The mobile device requires a camera function in order to scan the QR code.

As an alternative to the QR code, the MAC address given on the sticker can also be entered using the keyboard.

→ The linked device appears in the device overview of the JU-Control App. After

selection of the device, the device menu opens.

### 6.3 Further options within the app

The JU-Control App also offers the possibility of

- Adding further devices and locations. Further devices being added to the already specified location or a newly created location.
- The devices and locations being used by other users. Defining and enabling other users for operation of devices, e.g. the installer for the purpose of remote control or family members and tenants.
- Activating of message services in the user administration of the app menu, which e.g. indicate that the water supply has been shut off. These messages can be sent as desired via E-mail, text message or push message.

### 6.4 Control via Amazon Alexa



**Prerequisite for operating the device via Amazon Alexa is the installation of the connectivity module available as an accessory (see chapter 10.3).**

The leakage protection system is compatible with Alexa and can be operated by voice command.

Details on activation, configuration and voice commands can be found under <https://judo.eu/alexa>.



## 7 Fault domestic water station

Fault	Possible cause	Remedy
Backwash water continues running.	Backwash valve is not fully closed.	Repeat backwashing and then turn the handwheel fully home to the stop.
	Dirt in backwash valve.	
Water flow decreases.	Sieve clogged.	Perform backwashing.
There are leaks in the filter bowl.	Damaged seals.	Inform the installer or the closest customer service point.
Filter bowl becomes clouded.	Filter bowl was exposed to high temperatures or solvents.	<ul style="list-style-type: none"> <li>• Inform the installer or the closest customer service point.</li> <li>• If water escapes, close shut-off valves. Have the filter bowl replaced immediately.</li> </ul>
Hairline cracks on the filter bowl.		

Table 3: Troubleshooting

## 8 Warning message / fault leakage protection system

The display indicates the type of limit value overshoot. An audible interval tone sounds unless the setting for the tones has been changed (see chapter 5.2).

Display	Possible cause	Remedy
Alternating: <div>Leakage protect closed</div>	Limit value has been exceeded.	First check whether a leak is present. If no leak can be identified: <ul style="list-style-type: none"> <li>Delete message (OK)</li> </ul>
<div>Water quantity exceeded</div>	Hole or crack in a pipe or hose; water valve or flushing box valve not fully closed.	
or <div>Water flow exceeded</div>	Pipe break; Several withdrawal points opened simultaneously.	
or <div>Withdrawal time exceeded</div>	Hole or crack in a pipe or hose; Water tap or flushing box valve not fully closed.	
<div>To open press &lt;OK&gt;</div>		

Table 4: Help for warning / fault messages

Display	Possible cause	Remedy
<p>Alternating:</p> <div>Leakage protect closed</div> <div>Water quantity exceeded</div> <p>or</p> <div>Water flow exceeded</div> <p>or</p> <div>Withdrawal time exceeded</div> <div>Current limit XXXX l/h</div> <div>To open press &lt;OK&gt;</div> <div>For setting press &lt;▲/▼&gt;</div>	During learning mode a limit value was exceeded.	<p>First check whether a leak is present. If no leak can be identified:</p> <ul style="list-style-type: none"> <li>• Delete message (OK)</li> <li>• Or optionally the current setting for the limit value can be displayed and changed using the arrow keys, and saved using the OK key.</li> </ul>

Table 4: Help for warning / fault messages

Display	Possible cause	Remedy
<p>Alternating:</p> <div>Leakage protect closed</div> <div>Leakage sensor leakage warning</div> <div>To open press &lt;OK&gt;</div>	<p>The connected floor sensor (accessory) has detected a leak.</p>	<p>First check whether a leak is present. If no leak can be identified:</p> <ul style="list-style-type: none"> <li>Acknowledge message.</li> </ul>
<p>Alternating:</p> <div>Leakage protect closed</div> <div>Small leakage occurred</div> <div>To acknowledge press &lt;OK&gt;</div>	<p>During micro leakage testing, a micro leak has been detected.</p> <p>Possible causes e.g.</p> <ul style="list-style-type: none"> <li>Dripping water tap</li> <li>Leaking filling valve of a toilet cistern</li> <li>Leaking water pipe</li> </ul>	<p>Acknowledge message. If the cause cannot be identified, but the message is still regularly displayed: Call in a plumber to investigate the cause of the leak.</p>
<div>No water flow for 15 days</div>	<p>No water flow has occurred for 15 days (with setting vacation mode <i>off</i>).</p>	<p>If message correct: Press OK to delete the display. If message incorrect: Arrange for a functional test by the installer or JUDO service.</p>
<div>Attention! Fault .....</div>	<p>The device has a technical defect.</p>	<p>Inform the installer or JUDO service.</p>

Table 4: Help for warning / fault messages

Deleting warning messages:

- Press OK key.  
or
- Disconnect the power supply unit from the socket and plug back in after about 5 seconds.



When contacting JUDO service always specify the device ID (identification number) (see chapter 5.10).

## 9 Servicing

and wear materials as well as for possible repairs.

### 9.1 Cleaning



#### CAUTION

**Do not use household cleaning agents to clean the outside of the device, but only use clear water to avoid embrittlement of the plastic.**

### 9.2 Warranty and maintenance

To ensure the process operates successfully as long as possible, regular inspection and routine servicing of the device are essential. Where home automation is concerned, this is governed by DIN EN 806-5.

#### At least every 6 months

- ▶ Perform a visual inspection on the device
- ▶ Check whether a status display or a warning message is displayed
- ▶ As a test, close and reopen the leakage protection (see chapter 5.4.2)

To achieve fault-free operation, the leakage protection system performs regular automatic processes the purpose of which is to protect important functional parts.

We recommend the conclusion of a maintenance contract, which is the best way to ensure a good operating function, even beyond the warranty period. The skilled tradesmen or the factory customer service are suitable partners for regular maintenance work and the supply of consumables

## 10 Technical data

### JUDO PIPE-CARE SYSTEM JPCS-FB JPCS-FB

Micro-leakage protection system with integrated backwash protective filter and limescale prevention unit

The water to be filtered must comply with the European Drinking Water Directive.

Information about:		JPCS-FB ¾"	JPCS-FB 1"	JPCS-FB 1¼"
Pipe connection		¾"	1"	1¼"
Backwashing volume flow <sup>1)</sup>		0.3 L/s	0.3 L/s	0.3 L/s
Nominal pressure		PN 10		
Operating pressure		1.5 - 10 bar		
Rated flow after backwashing with a pressure loss of 0,5 bar		2.0 m³/h	2.7 m³/h	3.0 m³/h
Mesh size sieve insert		100 µm / 0.1 mm		
Water temperature and ambient temperature		max. 30 °C		
Air humidity		non condensing		
Threaded connection according to		DIN EN 10226-1		
Power connection		230 V AC / 50 Hz		
Power consumption Operation (leakage protection)		3 W		
Power consumption at opening / closing (leakage protection)		10 W		
Protection class		IP 22		
Adjustable limit values	Maximum water quantity	100 L - 3000 L		
	Maximum water flow	500 L/h - 5000 L/h		
	Maximum water with-drawal time	10 min - 10 h		
Weight		3.6 kg	3.8 kg	4.2 kg
Order no.		8140039	8140040	8140041

1) Applies to a fully opened backwashing valve and 2 - 3 bar mains pressure

## 10.1 Installation dimensions

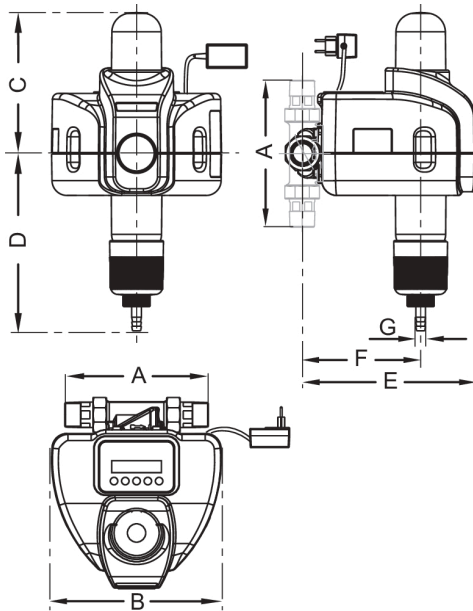

	JPCS-FB ¾"	JPCS-FB 1"	JPCS-FB 1¼"
A	180	195	230
B	227	227	227
C	187	187	187
D	236	236	236
E	231	231	236
F	157	157	162
G	13	13	13

Table 5: Dimensions without unit in mm

- A Installation length
- B Device width
- C Height above the pipe middle
- D Height below the pipe middle
- E Installation depth up to the pipe middle
- F Waste water connector mid. to pipe mid.
- G Waste water nominal diameter

## 10.2 Connection options



### CAUTION

The device may only be installed by qualified technical personnel.

The power supply unit must be disconnected to make the electrical installation.

The micro leakage protection system can be extended by one of the following devices or functions using the leakage protection (LS) input:

- JUDO floor sensor (up to 9 pcs)

The floor sensor triggers in the event of a water accumulation on the ground; the signal triggers the immediate shut-off of the water supply in the micro leakage protection system.

- Sleep mode

For use with devices that depend on an uninterrupted water supply. Short-circuiting the input, e.g. by a relay contact or by a simple switch, causes the micro leakage protection system to stop monitoring the set limit values and interrupts vacation mode if it has been activated. After opening of the switch or relay contact, the originally set limit value monitoring is once again active.

- External opening and closing of the water supply

To be used for immediate closing or opening of the water supply by an external switch or relay contact.

**Attention!** The operation of the leakage protection input must be set in the menu of the micro leakage protection system.



In the factory, the operating mode of the leakage protection system input is set to connection of one or more floor sensors.

Connection: see chapter 10.4

### Change the type of connected device via the **M** key:

1. Press key M.
2. Select *Setting* using the arrow keys and confirm with the OK key.
3. Select *Leakage protection* and confirm.
4. Select *Leakage protection (LS) input* and confirm.
5. Select one of the following settings and confirm.

Input (LS)

- Floor sensor

or

Input (LS)

- Sleep mode

or

Input (LS)

- Close mode

→ The connection is set to the desired device type or the desired setup.

## 10.3 Accessories

- JUDO floor sensor incl. connection cable, 2 metres, order No. 8203554
- Each additional floor sensor (max. 9 pcs): JUDO floor sensor, incl. connection cable, 2 metres, and branch connector, order No. 8203556
- JUDO connection cable for floor sensor, 2 metres, order No. 8203551
- JUDO connection cable for floor sensor, 5 metres, order No. 8203552
- JUDO connection cable for floor sensor, 10 metres, order No. 8203553
- JUDO cable for external fault message, 10 metres, order No. 2200717
- JUDO Connectivity-Module (LAN), order No. 2202271
- JUDO WLAN-Repeater, for connecting the JUDO Connectivity-Module to a WLAN home network (2 GHz) via LAN connection (with external antennas; power supply 230 V / 50 Hz), order No. 2202228



## 10.4 Electronic control unit

Input LS adapter cable for floor sensor  
or sleep mode or close mode

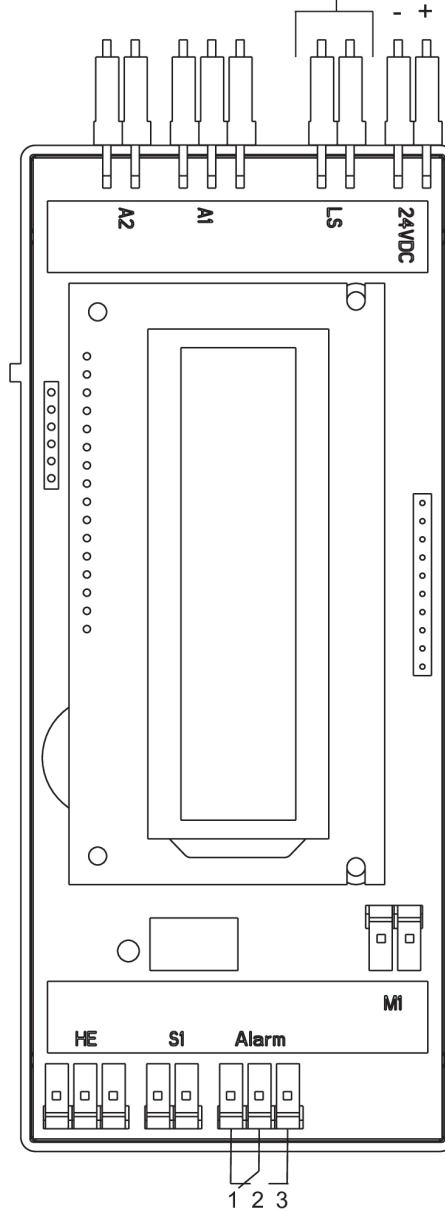

### 10.4.1 Connection potential-free message

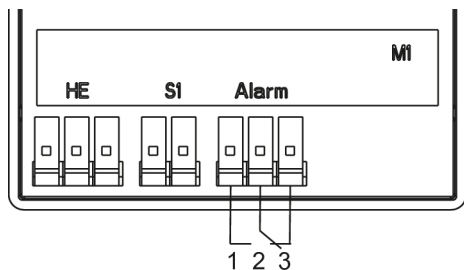

Function: Normally Closed Contact

- 1-2: operating
- 2-3: zero-current / fault / leakage alarm

Function: Normally Open Contact

- 1-2: zero-current / fault / leakage alarm
- 2-3: operating

## 10.5 Spare parts

JPCS-FB ¾" - 1¼"

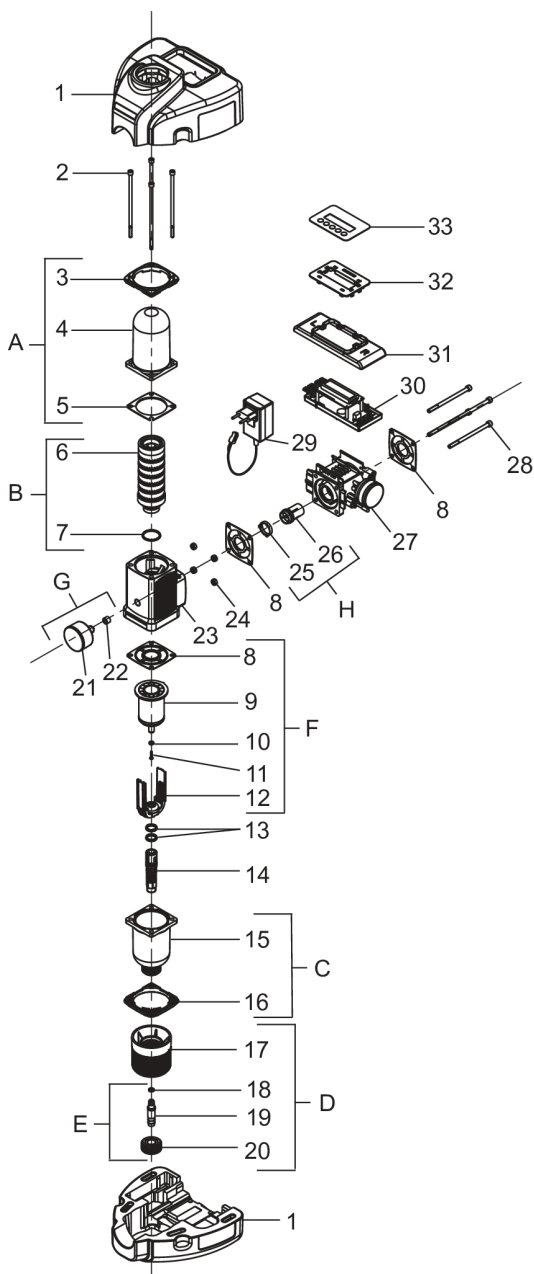

Item	Designation	Pcs	Order No.	AU <sup>1)/</sup> piece
A	Spare parts set <i>Filter bowl and flange ring</i> (consisting of pos. 3, 4, 5)	1	2140168	AU <sup>2)</sup>
B	Spare parts set <i>Limescale prevention unit</i> (consisting of pos. 6, 7)	1	2210428	85
C	Spare parts set <i>Filter bowl</i> (consisting of pos. 8, 15, 16)	1	2170441	105
D	Spare parts set <i>Handwheel backwashing</i> (consisting of pos. 17, 18, 19, 20)	1	2160236	17
E	Spare parts set <i>and union nut</i> (consisting of pos. 18, 19, 20)	1	2170182	10
F	Wear parts set <i>Sieve 0.1 mm and suction pipe ****</i> (consisting of pos. 8, 9, 10, 11, 12)	1	2170606	55
G	Spare parts set <i>Pressure gauge</i> (consisting of pos. 21, 22)	1	2150021	20
H	Spare parts set <i>Turbine and circlip</i> (consisting of pos. 25, 26)	1	2140117	45
--	Wear parts set <i>Valve and gaskets ****</i> (consisting of pos. 8, 2×13, 14, 18, 19)	1	2160240	18
--	Wear parts set <i>Gaskets</i> (consisting of pos. 2×8, 10, 11, 2×13, 18, 22)	1	2070334	36
1	Insulating shell set	1		
2	Cylinder screw M5×140 (Set with 4 pcs)	1	2140166	AU <sup>2)</sup>
3	Flange ring Ø 5,5 mm	1		
4	Filter bowl, transparent	1		
5	Profile flange gasket without web (set with 2 pcs) **	1	2110107	9
6	Limescale prevention unit	1		
7	O-ring 28×2,5	1		
8	Profile flange gasket **	3	2250219	6
9	Sieve insert	1		
10	Suction pipe gasket	1		
11	Sheet metal screw 2,9×16	1		
12	Suction pipe	1		

Table 6: List of spare parts

Item	Designation	Pcs	Order No.	AU <sup>1)</sup> / piece
13	O-ring 16×2,5	2		
14	Flush valve	1		
15	Filter bowl	1		
16	Flange ring M5	1		
17	Handwheel	1		
18	O-ring 6,07×1,3	1		
19	Hose connection piece	1		
20	Union nut	1		
21	Pressure gauge	1		
22	Pressure gauge seal	1		
23	Housing complete	1		
24	Hexagonal nut M6 (Set with 4 pcs)	1	2060448	6
25	Circlip	1		
26	Turbine	1		
27	Housing micro-leakage protection system	1		
28	Cylinder screws M6×100	4		
29	Power supply unit	1	2210560	65
30	Electronic control	1	2140162	AU <sup>2)</sup>
33	Membrane keypad	1	2201863	83

Table 6: List of spare parts

1) AU = Accounting unit (items without AU are only available in a set)

2) AU not yet specified at the time of going to press

Replacement interval:

\*\* = 2 years

\*\*\*\* = 4 years

## 11 Disposal

Packaging waste is to be sent to the local recycling system.



To protect environment, old appliances must not be disposed of with household waste. Instead, use the local collection and return points, which are committed to free and environmentally sound disposal.

## 12 EC Conformity Declaration

 <b>Wasser- Aufbereitung</b>	<b>EC Conformity Declaration</b>	Document no. 487 / 01.23
---	----------------------------------	-----------------------------

Manufacturer: JUDO Wasseraufbereitung GmbH

Address: Hohreuschstraße 39 - 41  
D-71364 Winnenden

**Product description:**

JUDO PIPE-CARE SYSTEM JPCS-FB JPCS-FB ¾" - 1¼"  
Micro-leakage protection system with integrated backwash  
protective filter and limescale prevention unit

- |                         |  |                              |
|-------------------------|--|------------------------------|
| • EC Directive:         | Restriction of the use of certain hazardous substances in electrical and electronic equipment (RoHS) | 2011/65/EU                   |
| • EC Directive:         | Electromagnetic Compatibility (EMC)  | 2014/30/EU                   |
| • Harmonized Standards: | Electromagnetic compatibility, generic standards for radiated interference and interference immunity | EN 61000-6-2<br>EN 61000-6-3 |
| • Harmonized Standards: | Safety of power transformers, power supplies, reactors and similar products                          | EN 61558-1                   |

The observance of the mentioned directives and EMC requirements for the use of the device in household, commercial and industrial areas as well as the application of the indicated standards are hereby confirmed.

Issuer: JUDO Wasseraufbereitung GmbH

Place and date: Winnenden, 21 January 2023

Legally binding signature:

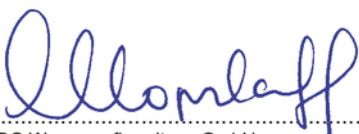
  
 .....  
 JUDO Wasseraufbereitung GmbH

The sole responsibility for issuing this Declaration of Conformity lies with the manufacturer. This declaration certifies that the product is in accordance with all the stated directives; it is however not an assurance of its characteristics.

## 13 Maintenance log

Product designation:

Micro-leakage protection system with  
integrated backwash protective filter and  
limescale prevention unit

Order number:

Serial number:

Date	Work activities performed	Company / signature

## 14 Customer service

DE	<b>JUDO Wasseraufbereitung GmbH</b> Postfach 380 • D-71351 Winnenden Phone +49 (0)7195 / 692-0 E-mail: info@judo.eu • judo.eu
AT	<b>JUDO Wasseraufbereitung GmbH • Niederlassung Österreich</b> Josef-Sandhofer-Straße 15 • A-2000 Stockerau Phone +43 (0)22 66 / 6 40 78 • Fax +43 (0)22 66 / 6 40 79 E-mail: info@judo-online.at • judo-online.at
CH	<b>JUDO Wasseraufbereitung AG</b> Industriestrasse 15 • CH-4410 Liestal Phone +41 (0)61 906 40 50 • Fax +41 (0)61 906 40 59 E-mail: info@judo-online.ch • judo-online.ch
BENELUX	<b>JUDO Wasseraufbereitung GmbH • Filiaal - Filiale Benelux</b> Laarbeeklaan - Av. du Laerbeek, 72 A1 • B-1090 Brussel-Bruxelles Phone +32 (0)24 60 12 88 • Fax +32 (0)24 61 18 85 E-mail: info.benelux@judo.eu • judo.eu
FR	<b>JUDO France SARL</b> 76 Rue de la Plaine des Bouchers (Technosud) • F-67100 Strasbourg Phone +33 (0)3 88 65 93 94 • Fax +33 (0)3 88 65 98 49 E-mail: info@judo.fr • judo.fr

Installed by / on:

All pictorial, dimensional and implementation information correspond to the date of going to press. We reserve the right to make changes due to technical progress and continuing development. Model and product claims cannot be lodged.